

125.00mts

LOTE NO. B-7
CALLE DE POR MEDIO

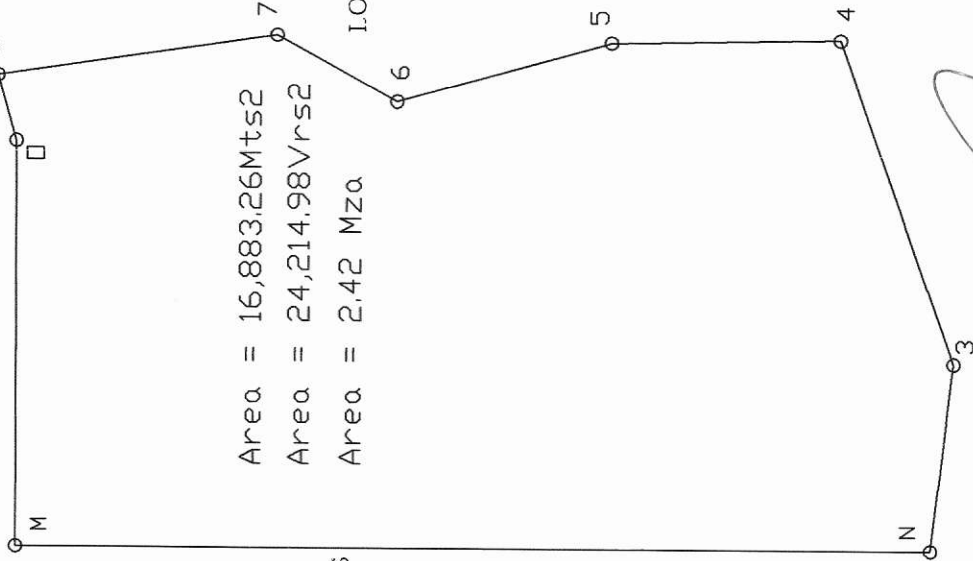

Area = 16,883.26Mts2
Area = 24,214.98Vrs2
Area = 2.42 Mza

479.35 mts

LOTES
A-6
A-7
A-8
A-12

LOTE NO. A-4

QUEERADA

TATA JULIAN

215.00mts

Estacion	Distancia	Rumbo
M - N	177.82	S65 52'00"E
N - 3	36.92	N31 13'00"E
3 - 4	67.00	N05 00'00"E
4 - 5	44.56	N66 36'00"W
5 - 6	43.35	N81 26'00"W
6 - 7	26.69	N36 25'00"W
7 - 8	55.00	N74 13'00"W
8 - □	13.31	S8 28'22"W
□ - M	81.31	S24 08'00"W

Proyecto: Plano de Terreno

Proprietario: Herederos Zepeda Durón

Ubicación: Municipio de Valle de Angeles
Departamento de Francisco Morazán

Dibujó: Ing. Julio R. Pineda CICH 3105

Cálculo: Ing. Julio R. Pineda CICH 3105

Aprobó: Ing. Julio A. Pineda E. CICH 267

Escala: 1:500 Fecha: 13 de Enero, 2010

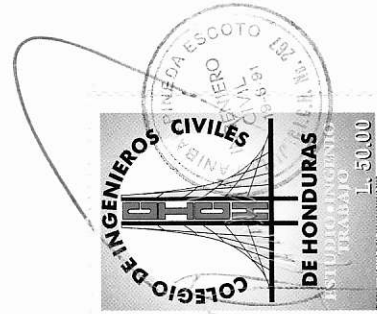

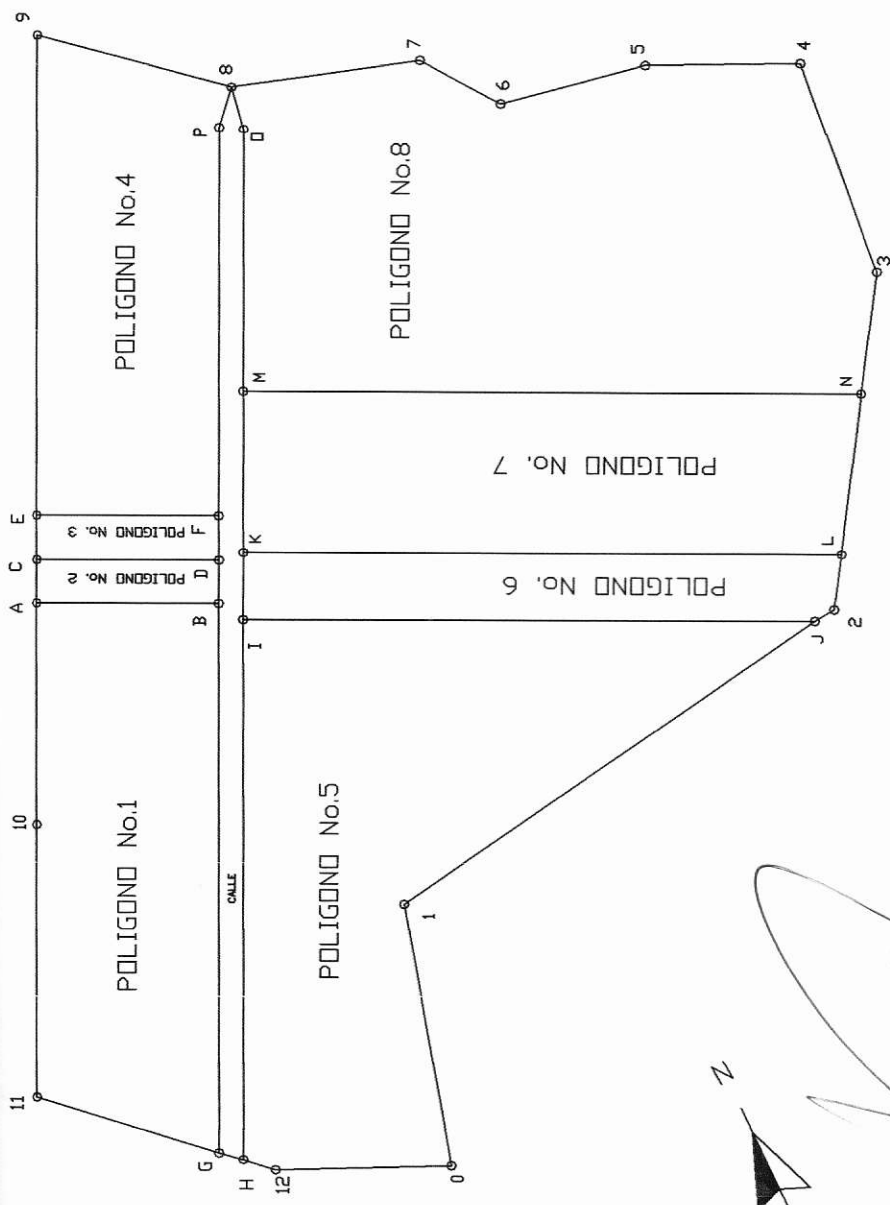

Proyecto: Plano de Terreno
 Propietario: Rosa Lastenia Zepeda Calderón
 Ubicación: Municipio de Valle de Angeles
 Departamento de Francisco Morazán
 Dibujó: Ing. Julio R. Pineda
 Calculó: Ing. Julio R. Pineda
 Aprobó: Ing. Julio A. Pineda E. CICH 267
 Escala: 1:2000 Fecha: 7 de Junio, 2001

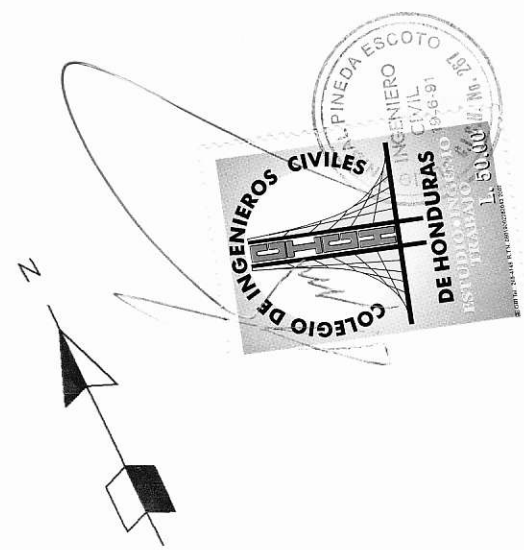

POLIGONO No. 6

Estacion	Distancia (Mts)	Rumbo
1 - J	164.84	S65°52'E
J - 2	5.92	N77°54'E
2 - L	17.02	N31°13'E
L - K	171.73	N65°52'W
K - I	20.52	S24°08'W

Area = 3,486.12 Mts²

Area = 5,000.0 Vrs²

Area = 0.50 Mza

POLIGONO No. 7

Estacion	Distancia (Mts)	Rumbo
M - K	48.75	S24°08'W
K - L	171.73	S65°52'E
L - N	49.13	N31°13'E
N - M	177.82	N65°52'W

Area = 8,516.57 Mts²

Area = 12,214.98 Vrs²

Area = 1.22 Mza

POLIGONO No. 8

Estacion	Distancia (Mts)	Rumbo
M - N	13.28	S65°52'E
N - 3	52.50	N31°13'E
3 - 4	13.28	N05°00'E
4 - 5	52.50	N66°36'W
5 - 6	52.50	N81°26'W
6 - 7	52.50	N36°25'W
7 - 8	52.50	N74°13'W
8 - O	52.50	S8°28'22"W
O - M	52.50	S24°08'W

Area = 16,883.26 Mts²

Area = 24,214.98 Vrs²

Area = 2.42 Mza

Resumen General de Areas

Poligono	Mts ²	Vrs ²	Mza
1	8,366.68	12,000.00	1.20
2	697.22	1,000.00	0.10
3	697.22	1,000.00	0.10
4	7,259.90	10,412.59	1.04
5	13,397.14	19,214.59	1.92
6	3,486.12	5,000.00	0.50
7	8,516.57	12,214.98	1.22
8	16,883.26	24,214.98	2.42
Totales	59,304.12	85,057.53	8.51



POLIGONO No. 1

Estacion	Distancia (Mts)	Rumbo
10	67.08	S24°08'W
11	82.20	S25°03'W
G	56.64	S47°41'E
B	166.95	N24°08'E
A	52.50	N65°52'W

Area = 8,366.36 Mts²
 Area = 12,000.0 Vrs²
 Area = 1.20 Mza

POLIGONO No. 2

Estacion	Distancia (Mts)	Rumbo
C - A	13.28	S24°08'W
A - B	52.50	S65°52'E
B - D	13.28	N24°08'E
D - C	52.50	N65°52'W

Area = 697.22 Mts²
 Area = 1,000.0 Vrs²
 Area = 0.10 Mza

POLIGONO No. 3

Estacion	Distancia (Mts)	Rumbo
C	13.28	S24°08'W
D	52.50	S65°52'E
F	13.28	N24°08'E
E	52.50	N65°52'W

Area = 697.22 Mts²
 Area = 1,000.0 Vrs²
 Area = 0.10 Mza

POLIGONO No. 4

Estacion	Distancia (Mts)	Rumbo
9 - E	145.16	S24°08'W
E - F	52.50	S65°52'E
F - P	117.50	N24°08'E
P - 8	13.31	N39°00'57"E
8 - 9	58.04	N50°17'W

Area = 7,259.90 Mts²
 Area = 10,412.59 Vrs²
 Area = 1.04 Mza

POLIGONO No. 5

Estacion	Distancia (Mts)	Rumbo
1	163.23	S24°08'W
2	9.70	S47°41'E
0	50.69	N67°00'E
	80.19	N14°40'E
	145.94	N77°54'E
	164.84	N65°52'W

Area = 13,397.14 Mts²
 Area = 19,214.98 Vrs²
 Area = 1.92 Mza

